

# PLANNING APPLICATION NUMBER:P08/1778

|                         |  |
|-------------------------|--|
| Type of approval sought | Tree Preservation Order  |
| Ward                    | NORTON   |
| Applicant               | Mr Richard Vaughan-Hawkins                                     |
| Location:               | <b>6, OUNTY JOHN LANE, PEDMORE, STOURBRIDGE, DY8 2RG</b>       |
| Proposal                | <b>CROWN THINNING OF LARGE PINE AND REMOVAL OF SMALLER ONE</b> |
| Recommendation Summary: | <b>APPROVE SUBJECT TO CONDITIONS</b>                           |

## TREE PRESERVATION ORDER NO: D 171 (1985) – G15

### SITE AND SURROUNDINGS

1. The trees subject to this application are a mature and early mature pine trees that are situated in the rear garden of 6 Ounty John Lane. The trees are shielded by surrounding trees and can only be seen through a small number of gaps in the vegetation.

### PROPOSAL

2. Summary of proposals for the works as written on application form is as follows:
  - Fell 1 pine tree and crown thin 1 pine tree.
3. The trees have been marked on the attached plan.

### HISTORY

4. There has been one previous Tree Preservation Order application on this site.

|                     |                  |                          |
|---------------------|------------------|--------------------------|
| <i>Site History</i> |                  |                          |
| Application No      | P01/1124         | 03/08/01                 |
| Proposal            | Fell 1 Lime tree | Approved with conditions |

## PUBLIC CONSULTATION

5. No representations have been received,

## ASSESSMENT

### Tree(s) Appraisal

6.

| Criteria         | Tree 1                       | Tree 2       |
|------------------|------------------------------|--------------|
| TPO No           | G15                          | G15          |
| Species          | Scots Pine                   | Scots Pine   |
| Height           | 14m                          | 18m          |
| Spread           | 5m                           | 8m           |
| Diameter         | 550mm                        | 800mm        |
| Form             | Moderate / Poor - suppressed | Good         |
| Vigour           | Good                         | Good         |
| Approx Age       | Early Mature                 | Mature       |
| Pests / Diseases | None Evident                 | None Evident |
| Canopy           | Moderate / Poor              | Moderate     |
| % Deadwood       | 1%                           | 3%           |
| Cavities         | None Evident                 | None Evident |
| Bark             | Good                         | Good         |
| Roots            | Moderate - Lifting Slabs     | Moderate     |
| Overall Health   | Good                         | Good         |
| Visibility       | Moderate                     | Moderate     |
| Amenity Value    | Low                          | High         |

### Further Assessment

7. The applicant, who lives in the adjacent property to the trees, has proposed to fell Tree 1 of this application and crown thin tree 2.
8. Tree 1 is an early mature Scots Pine that has grown up in suppression of Tree 2. As such it has now developed a poor form and is totally dominated by Tree 2.
9. The applicant has proposed to fell the tree as the roots of the tree are lifting the slabs of their rear patio, causing a trip hazard. The applicant has stated that his children have already tripped over the lifted edges of slabs on two occasions.

10. Normally where tree roots are lifting slabs, consideration should be given to the alteration of the surface, before the felling of the tree would be recommended. However in this case the tree in question provides such a little amount of amenity, it is considered that approval should be given to fell the tree. Due to the trees suppression by tree 2, the removal will almost go unnoticed, and therefore there will be little or no impact on the amenity of the area.
11. The applicant has proposed to crown thin Tree 2 in order to reduce the congestion of branches within the crown, which has caused various small diameter branches to fail in the past.
12. The proposed crown thinning will serve to reduce the sail effect of the tree allowing more air to pass through the crown during windy weather. The result will be a reduction of mechanical force on the branches thereby reducing the potential for branch failure. It is considered that the crown thinning should be limited to 20%, which would serve to reduce the wind forces in the tree without overly altering its form and appearance thereby maintaining the amenity the tree provides to the area.

## **CONCLUSION**

13. The felling of the pine tree (Tree1) is considered to be appropriate as it provides a low amount of amenity to the area, and due to its suppression will never contribute anything substantial to the area. Whilst normally where surface distortion is the reason for felling, alternative surfaces should be considered before tree felling, in this case because of the low amenity value of the tree it is considered that the felling of the tree is an acceptable proposal.
14. The crown thinning of tree 2 is also considered appropriate as it will serve to reduce the number of branches that fail from the tree without having any impact on the amenity that the tree provides to the area.

## **RECOMMENDATION**

15. It is recommended that application is approved subject to the conditions set out below.

Conditions and/or reasons:

1. Notwithstanding any of the details on the submitted application forms, the works hereby approved are as follows: -  
Schedule:  
T1– Pine – Fell.  
T2 – Pine - Crown thin by no more that 20%. All works are to leave a healthy and well balanced crown.
2. The tree works subject of this consent shall be carried out in accordance with British Standard BS 3998:1989 `Recommendations for Treework'.
3. The works hereby approved shall be carried out within 12 months of the date of this decision.
4. A replacement tree shall be planted between the beginning of November and the end of March, within 1 year of felling (and replanted if necessary) and maintained until satisfactorily established. The size, species and location of the replacement tree shall be agreed in writing with the Local Planning authority prior to the felling of the trees to which this application relates.

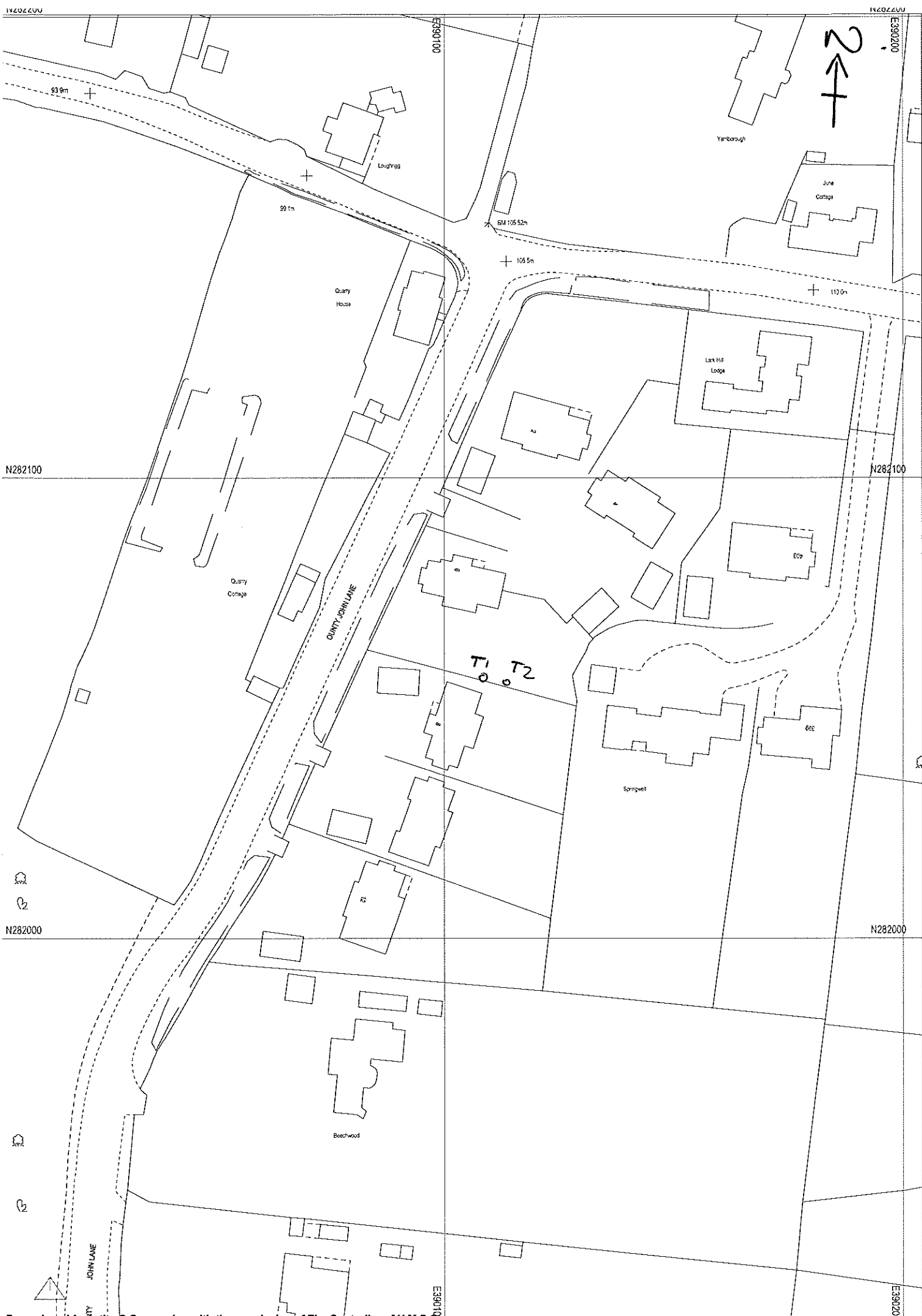

# DUDLEY METROPOLITAN BOROUGH

Base/Job No

Drawing No

B/1479

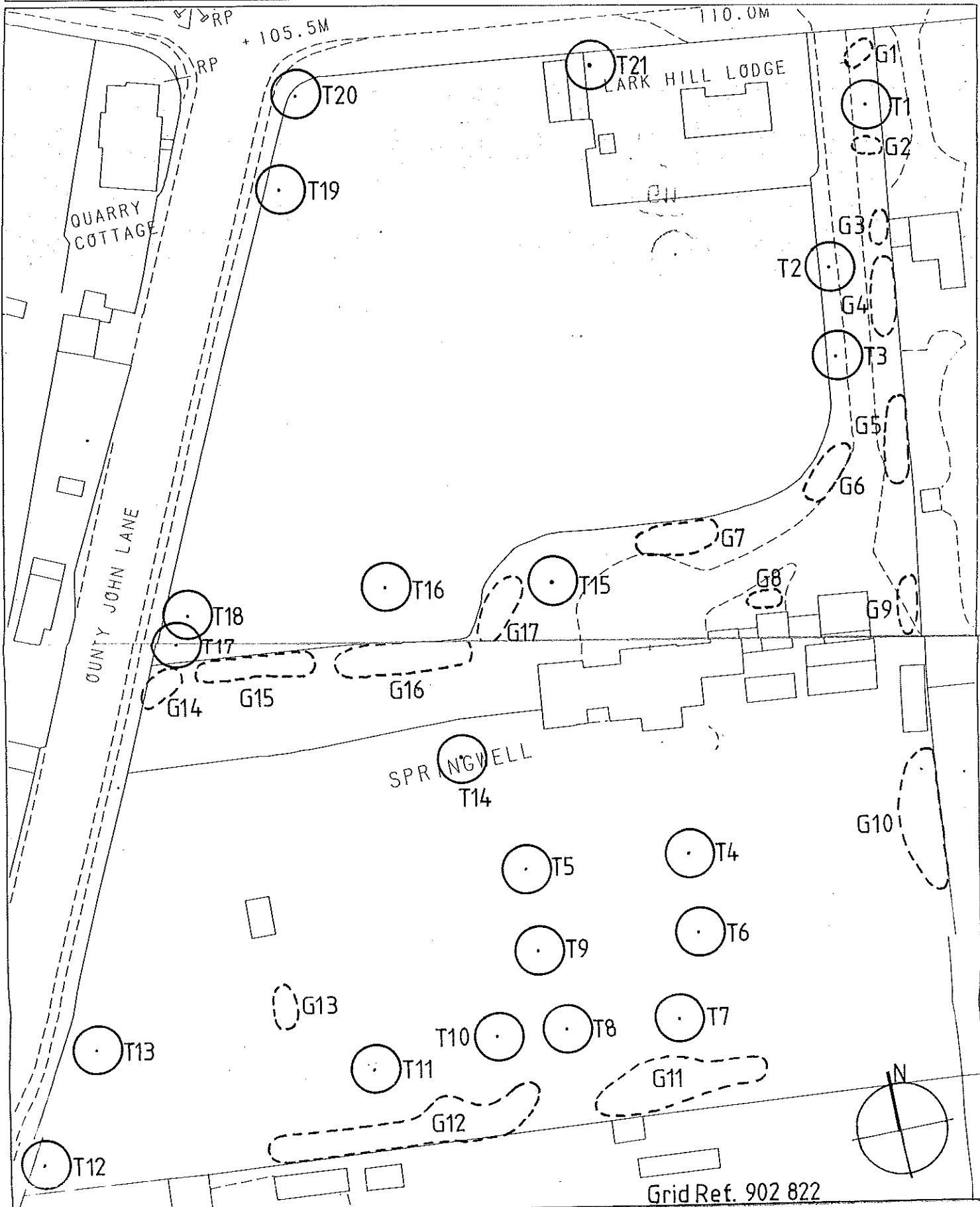

Grid Ref. 902 822

Title  
 Borough of Dudley ('Springwell',  
 Racecourse Lane, Pedmore.) T.P.O. 1985.

Scale:  
 1:500  
 Date:  
 4/12/85  
 By:  
 [Signature]

PLANNING AND ARCHITECTURE DEPARTMENT  
 Chief Planner/Architect  
 Alan R. Powell, R.I.B.A., M.B.I.M., F.R.S.A.  
 Borough Planner  
 Roger Johnson, B.A., Dip T.P., F.R.T.P.I.

BASED UPON THE ORDNANCE SURVEY MAP WITH THE SANCTION OF THE CONTROLLER OF H.M. STATIONERY OFFICE

FIRST SCHEDULE

Individual Trees

| <u>No.</u> | <u>Description</u> | <u>Location</u>                        |
|------------|--------------------|--|
| T1         | Larch              | 'Springwell', Racecourse Lane, Pedmore |
| T2         | Chestnut           | " " " "                                |
| T3         | Prunus spp         | " " " "                                |
| T4         | Cypress            | " " " "                                |
| T5         | Cypress            | " " " "                                |
| T6         | Cypress            | " " " "                                |
| T7         | Irish Yew          | " " " "                                |
| T8         | Irish Yew          | " " " "                                |
| T9         | Cypress            | " " " "                                |
| T10        | Cedar              | " " " "                                |
| T11        | Cypress            | " " " "                                |
| T12        | Cypress            | " " " "                                |
| T13        | Cypress            | " " " "                                |
| T14        | Birch              | " " " "                                |
| T15        | Cedar              | " " " "                                |
| T16        | Copper Beech       | " " " "                                |
| T17        | Lime               | " " " "                                |
| T18        | Lime               | " " " "                                |
| T19        | Horse-chestnut     | " " " "                                |
| T20        | Ash                | " " " "                                |
| T21        | Macracarpa         | " " " "                                |

Groups of Trees

|     |   |  |
|-----|---|--|
| G1  | One Corsican Pine   | 'Springwell', Racecourse Lane, Pedmore |
|     | One twin stemmed Cypress  | " " " "                                |
| G2  | One Larch, One Cypress  | " " " "                                |
| G3  | Two Corsican Pine<br>(One twin-stemmed)                                 | " " " "                                |
| G4  | Four Corsican Pines   | " " " "                                |
| G5  | One Cypress, One Scots<br>Pine, One Macracarpa                          | " " " "                                |
| G6  | <del>One Corsican Pine</del> , Four<br>Cypress                          | " " " "                                |
| G7  | Three Cypresses   | " " " "                                |
| G8  | One Yew, One Hemlock  | " " " "                                |
| G9  | Three Corsican Pines  | " " " "                                |
| G10 | Nine Corsican Pines   | " " " "                                |
| G11 | One Spruce, One Hawthorn,<br>Two Cypresses, One<br>Prunus, One Laburnum | " " " "                                |
| G12 | Three Cypresses, One<br>Cherry, Six Limes                               | " " " "                                |
| G13 | Two Cypresses   | " " " "                                |
| G14 | One Corsican Pine, One<br>Chestnut                                      | " " " "                                |
| G15 | Five Cypresses  | " " " "                                |
| G16 | Three Corsican Pines<br>Two Scots Pines, One Cypress                    | " " " "                                |
| G17 | Three Cypresses   | " " " "                                |

The foregoing schedule was substituted for the original schedule by Minute No.193 of the Planning and Architecture Committee held on 5th December, 1985.